

WIRELLOCK

WL 5-07

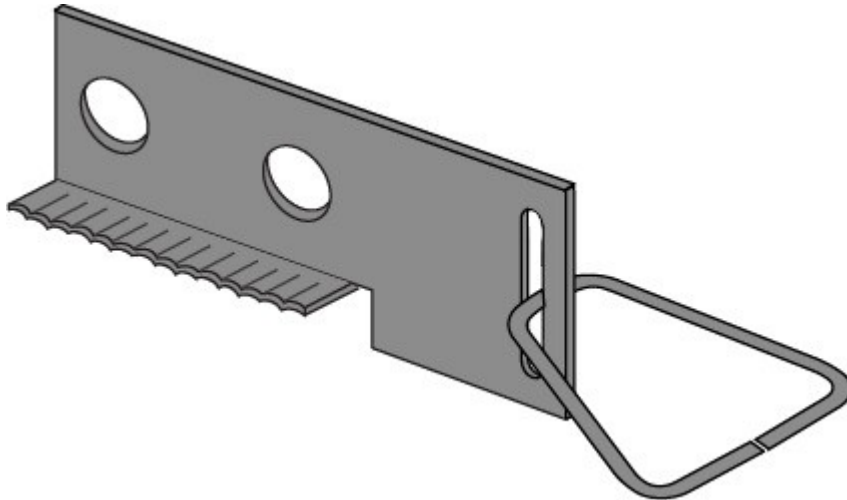

*Anchor plate only
(Ties sold separately)*

WIRELLOCK WL5-07 veneer anchor plate and tie system provides adjustability and differential movement between the masonry veneer and the structural wall system. The anchor plate is designed to be embedded in the masonry backup.

PRODUCT DATA

- Manufactured from 16 gauge sheet metal conforming to ASTM A366,
 - Conforms to CSA A370-14
- Hot Dipped Galvanized after Fabrication**
ASTM A153M-09, ASTM A123-13 (1.5 oz per sq. ft.)
- Stainless Steel Type 304**
16gauge, ASTM 167/A240/A240-13
- Designed for embedment in masonry backup
 - Plate length can accommodate various insulation thicknesses from 0" to 4"
- Base Plate Dimensions:**
- 16gauge (1.5mm) thick x 3" (75mm) wide with the length to accommodate various insulation thicknesses

FINISHES & SIZES

Finishes:

- Hot Dipped Galvanized after fabrication ASTM A153M-09, ASTM A123-13 (1.5 oz per sq. ft.)
- Stainless Steel: ASTM A580, A240, A240M-13, AISI Type 304 16 gauge, ASTM 167

Available Sizes:

0" Insulation	1" Insulation
1½" Insulation	2" Insulation
3" Insulation	4" Insulation

Distributed by:



Masonry Specialty Products Since 1977

2 Fogal Road, Woodbridge, Ontario L4L 1A5, Canada
T: 905-851-3744 or 416-746-8469 FAX: 905-851-4797
wirelocksales@jvbs.ca www.jvbs.ca